

550-004 HORIZONTAL / VERTICAL 5C COLLET INDEX



YUASA INTERNATIONAL
www.yuasa-intl.com

**2 YEAR
WARRANTY**

FEATURES:

- Spindle is manufactured with a taper seat in body frame.
- Rapid opening and closing is performed with a level collet closer with a leverage ratio of 100 to 1.
- Convenient ratchet mounted on front of spindle provides rapid indexing.
- Index plate has 24 index locations, (*15° increments*); any of these may be masked off for greater variety in applications.

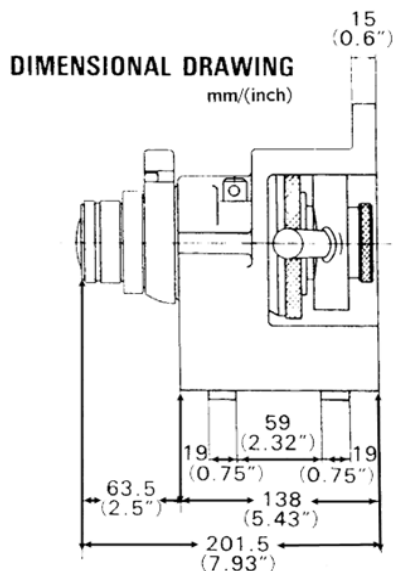
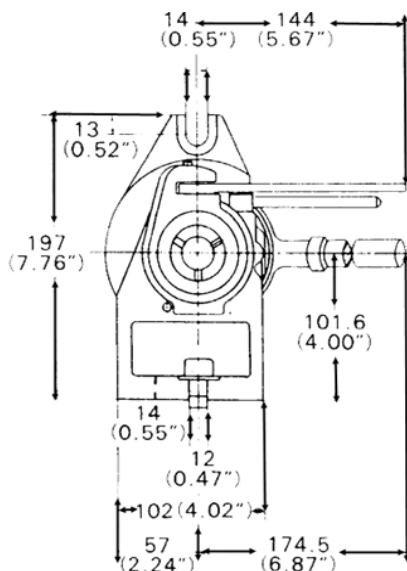
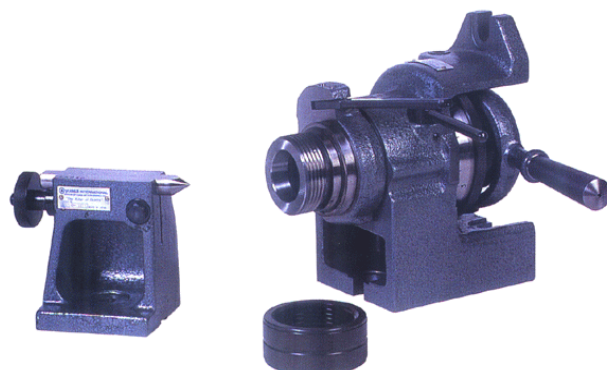

SPECIFICATIONS	MAXIMUM VARIATION Inch/(mm)	MODEL	DESCRIPTION	WEIGHT lbs kg
Dividing spindle concentricity	0.0002 (0.005)	550-004	Collet index	25 (11.3)
Cylindrical center bore (per 1") concentricity	0.0008 (0.02)	550-102	20 Division master plate for 550-004	2 (0.9)
Spindle center line parallelism	0.0008 (0.02)	550-103	Screw fed tailstock	15 (6.8)
Base to face squareness	0.0008 (0.02)			
Center slot to dividing spindle concentricity	0.0008 (0-02)			
Lateral offset of center slot of dividing spindle	0.0008 (0.02)			
Repeatability	10 seconds			
Indexing Accuracy	30 seconds			
Spindle Runout	0.0004 (0.01)			

OPERATION

Place workpiece into collet and adjust tightness with collet nut. Select indexing positions using index screw locators on master gear. Push the position lever to disengage the locator pin. Rotate the spindle to the desired position by depressing the index lever.